

HUSKY 300



Gebrauchsanleitung

Komfort-Schiebe-Befestigung
mit Druckschloß

Instructions for use

Comfort sliding fitting
with push button lock

Instructions d'utilisation

Montage glissé facile
avec la serrure de pression

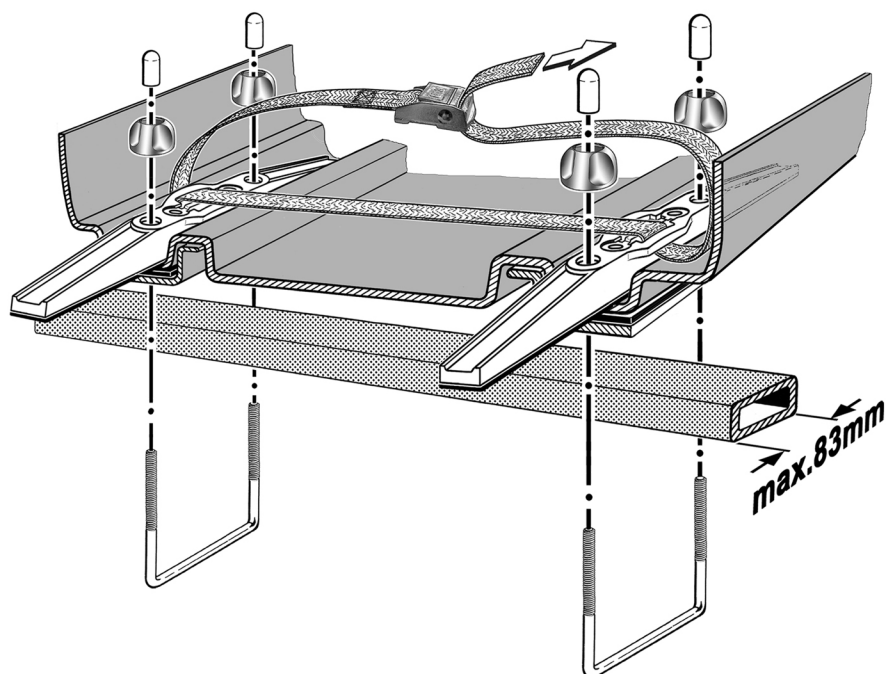
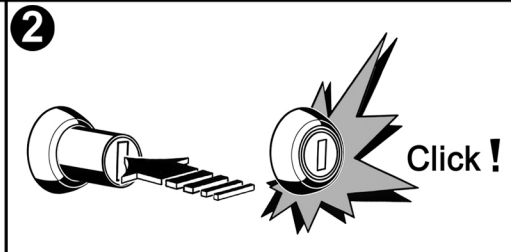
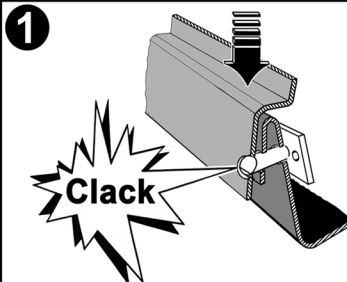
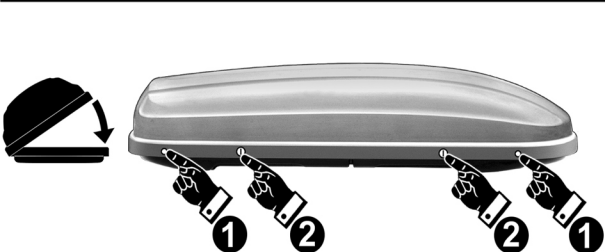
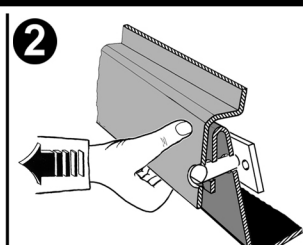
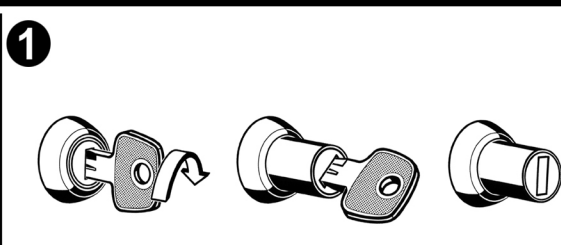
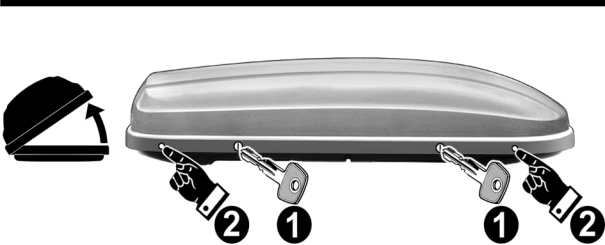
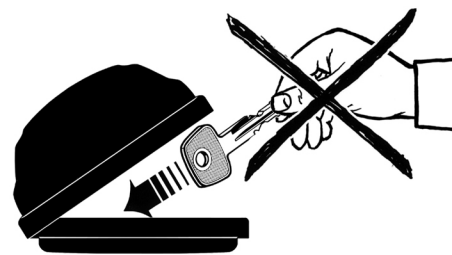
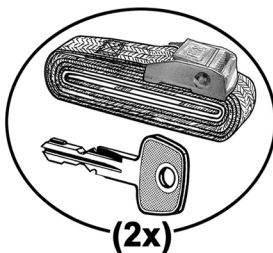
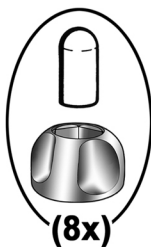
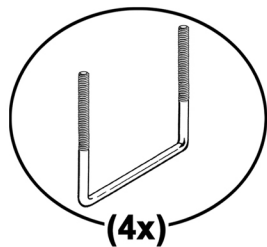

Art.-Nr. 0 52003 10
0 52005 10

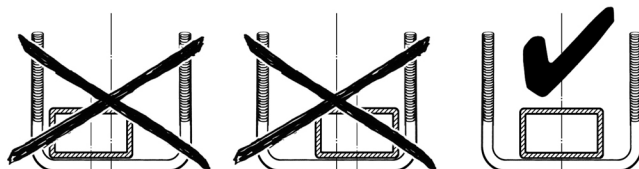
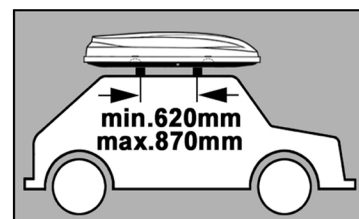
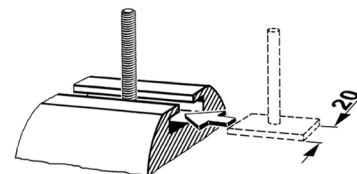

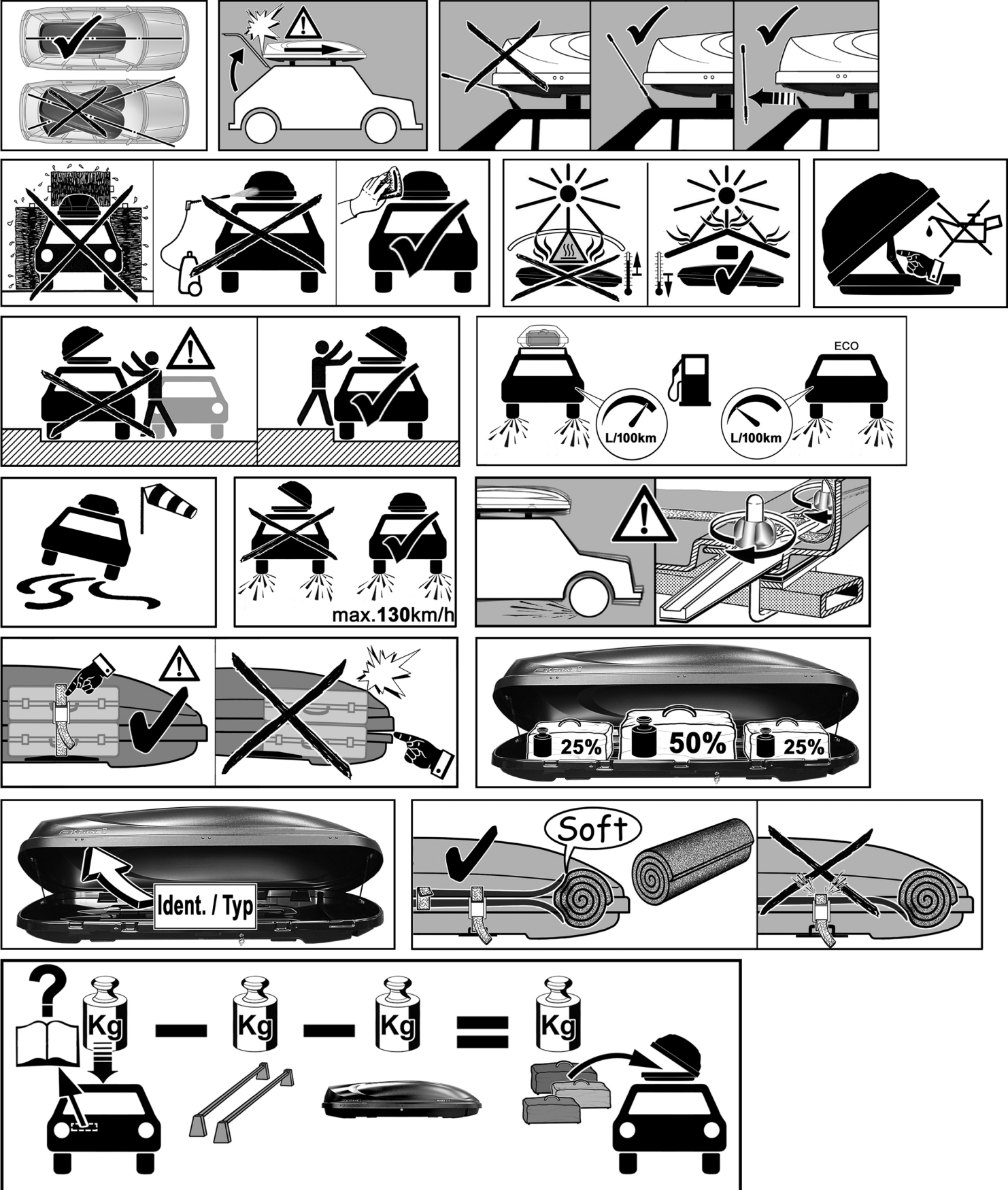

Dachcontainer Typ 81200

Hersteller: KAMEI

Haupt-Verkaufsbezeichnung Auch andere Verkaufsbezeichnungen sind genehmigt	Maße			Volumen Schüttgut Liter	Eigengewicht kg	Gewichte	
	Länge cm	Breite cm	Höhe cm			zulässige Tragfähigkeit kg	Maximalgewicht beladen kg
Husky 300	220	60	35	300	14	50	64